

COMFORT AT THE EXTREMES 2022 EXHIBITION PROSPECTUS



3rd International CATE Conference

CLIMATE CHANGE, COVID AND VENTILATION

CATE is a part of a global network that has led a worldwide discourse on Thermal Comfort in the Built Environment since 1994. Originally organised as eleven Windsor Conferences on Comfort (www.windsorconference.com), the delegates there were world leaders in their fields as lead international thinking on this important field, dealing with both HVAC focussed deliberations and also Adaptive Thermal Comfort developments over the last 30 years, underpinned by the NCEUB Network for Comfort and Energy Use in Buildings, with over 800 on-line members (www.nceub.org).



CATE 19 – DUBAI: Resilient Comfort. By 2018 it was becoming clear that rapid changes in the global climate meant that related professions and industries would have to make significant changes to design and system specifications to ensure that greenhouse gas emissions were reduced while ensuring that both buildings and their comfort systems could cope with ever more extreme weather events and trends, nowhere more so than in the extreme heat of the Gulf. The 1st CATE was organised by Heriot Watt University in Dubai with delegates from 21 countries: <https://comfortattheextremes.com/past-conferences/>

Comfort at the Extremes
Energy, Economy and Climate



CATE 21 – OMAN: Hosted by Sultan Qaboos University in Muscat This wide ranging conference attracted world leading speakers on subjects as diverse as COVID transmission, designing for climate change, cooling systems for extreme heat and the importance of the vernacular design approaches: www.cate21.com



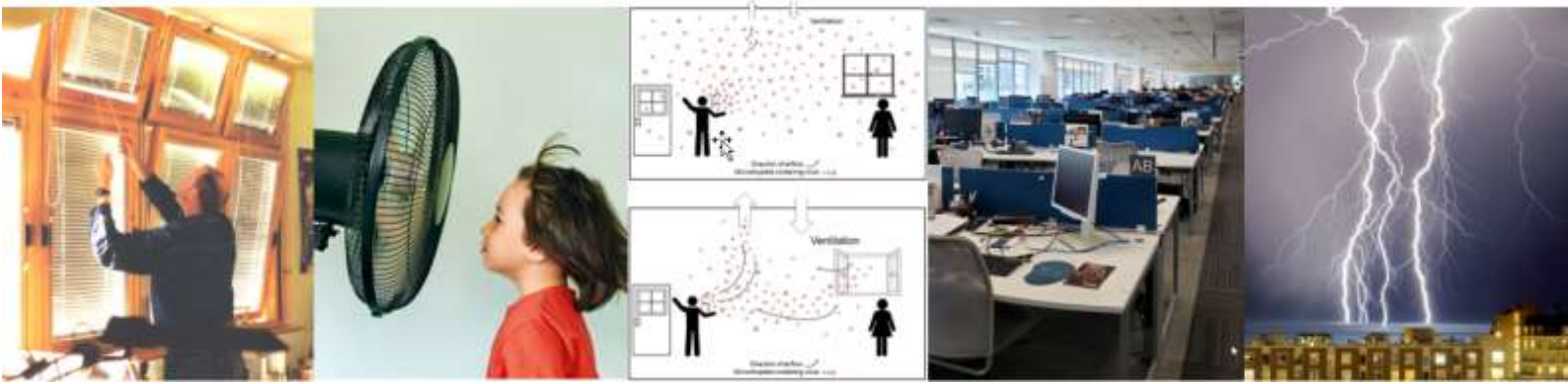

RESILIENT COMFORT: Climate Change COVID & Ventilation

Will be held on the 5th-6th September 2022, Edinburgh with In-Person and On-Line delegates attending. COVID and Climate Change have fundamentally altered the way buildings will have to be designed today, for a different tomorrow. Radical progress is now essential, and is happening, to create buildings that are ahead of the curve in wisely directing investments in rapidly evolving markets. Emerging research, new thinking and innovative design developments will be brought to CATE22 by academics, professionals, politicians and industry experts assembled to discuss and explore how to keep people safer, healthier and affordably comfortable in buildings and cities in a fast changing world. At the heart of many of the necessary step changes ahead is the need to provide resilient comfort indoors. A stellar list of keynote speakers on *COVID and Design*, will join leading *Comfort* researchers and experts involved in new approaches to the *Ventilation of Buildings* and related *Building Regulations and Standards*.

The CATE team in conjunction with Heriot Watt University and Historic Environment Scotland are hosting CATE22 to address such pressing design challenges: Comfort in relation to Climate Change, Covid and the Ventilation of Buildings. Learn more about the event on:

<https://comfortattheextremes.com/september-about/>

CATE 22 Venue: Set in the premier venue of the Royal College of Physicians of Edinburgh at 9 Queen Street, Edinburgh EH2 1JQ in the heart of Edinburgh's city centre (Visit), the College combines both a rich historic elegance with state of the art conference facilities.

<https://www.rcpe.ac.uk/>

CATE 22 EXHIBITION will run on both the 5th and the 6th of September days of the Conference and be located in the Conference Centre Foyer and the Great Hall. Delegates will mingle around the exhibition tables during and between sessions and over lunch and across the reception on the night of the 5th September, accompanied by local musicians and Scottish themed refreshments.



BENEFITS OF EXHIBITING AT CATE 22

- A unique opportunity to be involved with the latest international thinking on the leading issues in design for the built environment including Comfort, Climate Change, COVID and Ventilation
- Direct access to over 300+ leading-edge professionals, researchers, policy makers and thinkers in person and possibly the same again through on-line delegates. The CATE 22 delegates will include architects, engineers, planners, related academics and organisations
- The opportunity to showcase your products and services to Key Product Specifiers: Construction Firms, Architectural Practices, Universities, Local Authorities, Quantity Surveyors, M&E Engineers,
- The opportunity to cultivate business relations with existing and new clients through:
 - **10 Workshop sessions** on key subjects related to the Conference
 - **One complimentary conference registration.** This provides access to all conference talks and sessions, and the Conference Reception as a delegate.

YOU ARE INVITED TO EXHIBIT AT CATE 22



HOW TO SECURE A CATE 22 EXHIBITION SPACE

Indicative Costs of an Exhibition Table at CATE 22:

Space	Equipment	Cost
Edge Space Great Hall 1.5m x 1.5 m (8 available)	Table with white linen (1.5 m x 0.6m), chair, Poster Board (1.5x 0.6m), power	£1500
Edge Space Foyer 1.5m x 1.5 m (6 available)	Table with white linen (1.5 m x 0.6m), chair, Poster Board (1.5x 0.6m), power	£1250

Notes: Final layout may vary and if you require a non-standard set of equipment or for more information on particular Exhibition options and costs contact our Exhibition Director on enquiries@comfortattheextremes.com

Following provisional agreement by email or phone, your exhibition option will be held for you for 21 working days. During this time it can be secured by completing and returning a CATE 22 Exhibition Form along with a deposit of £25%. Full payment is due within 3 months of receipt of your reservation request, or by 1st August 2022, whichever is the earlier.

RCPE Foyer and Great Hall Plans

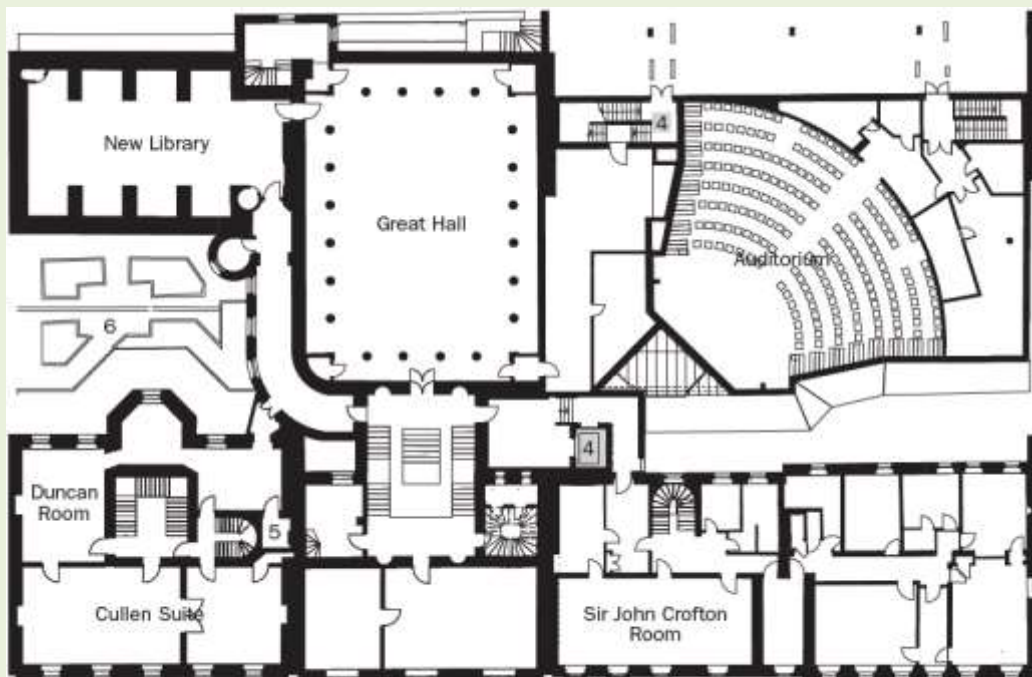
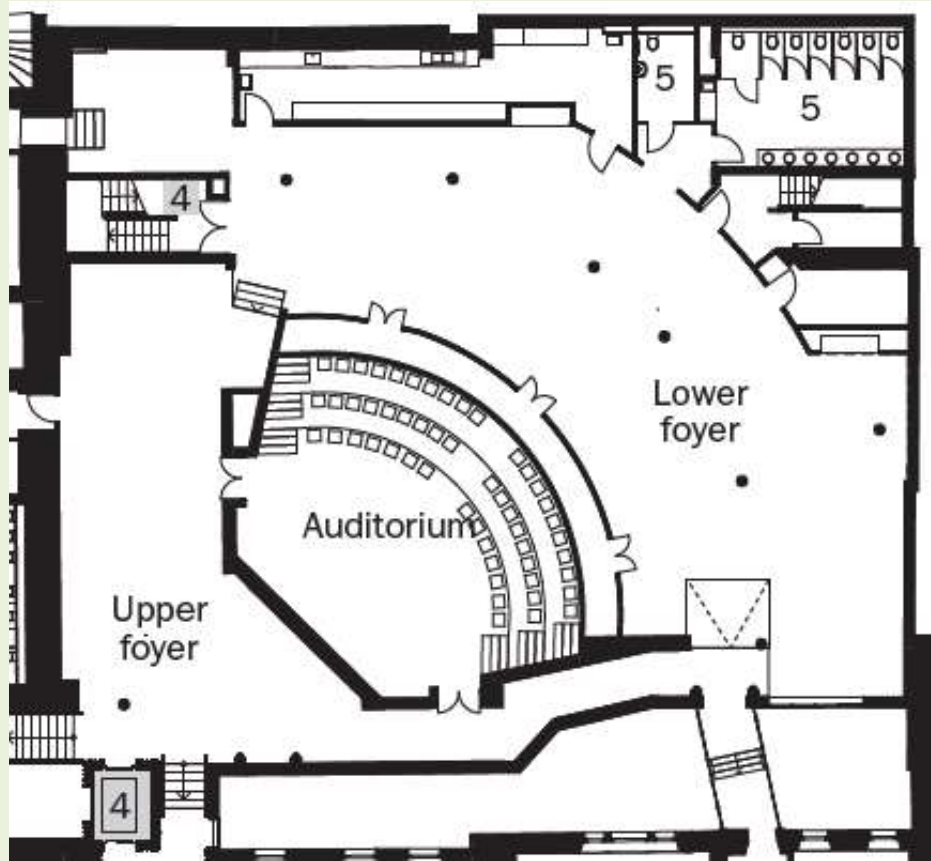

Great Hall/mld level